

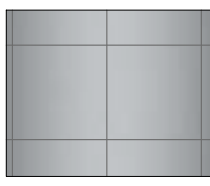

**LEGEND**

-  CONCRETE SLABS - CHARCOAL
-  CONCRETE SLABS - DESERT SAND
-  PICNIC TABLE
-  WASTE RECEPTACLE
-  BARBECUE - 2 PER ROOFTOP AMENITY

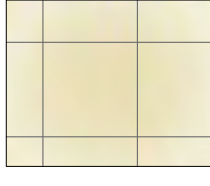
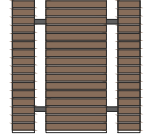

PICNIC TABLES



WASTE RECEPTACLE

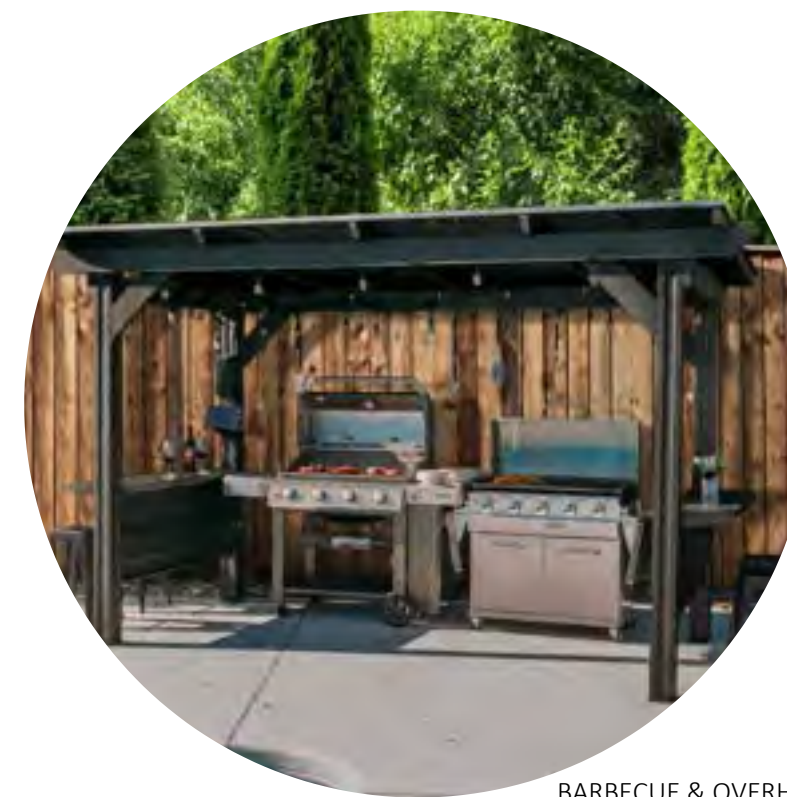

BARBECUE & OVERHEAD TRELLIS

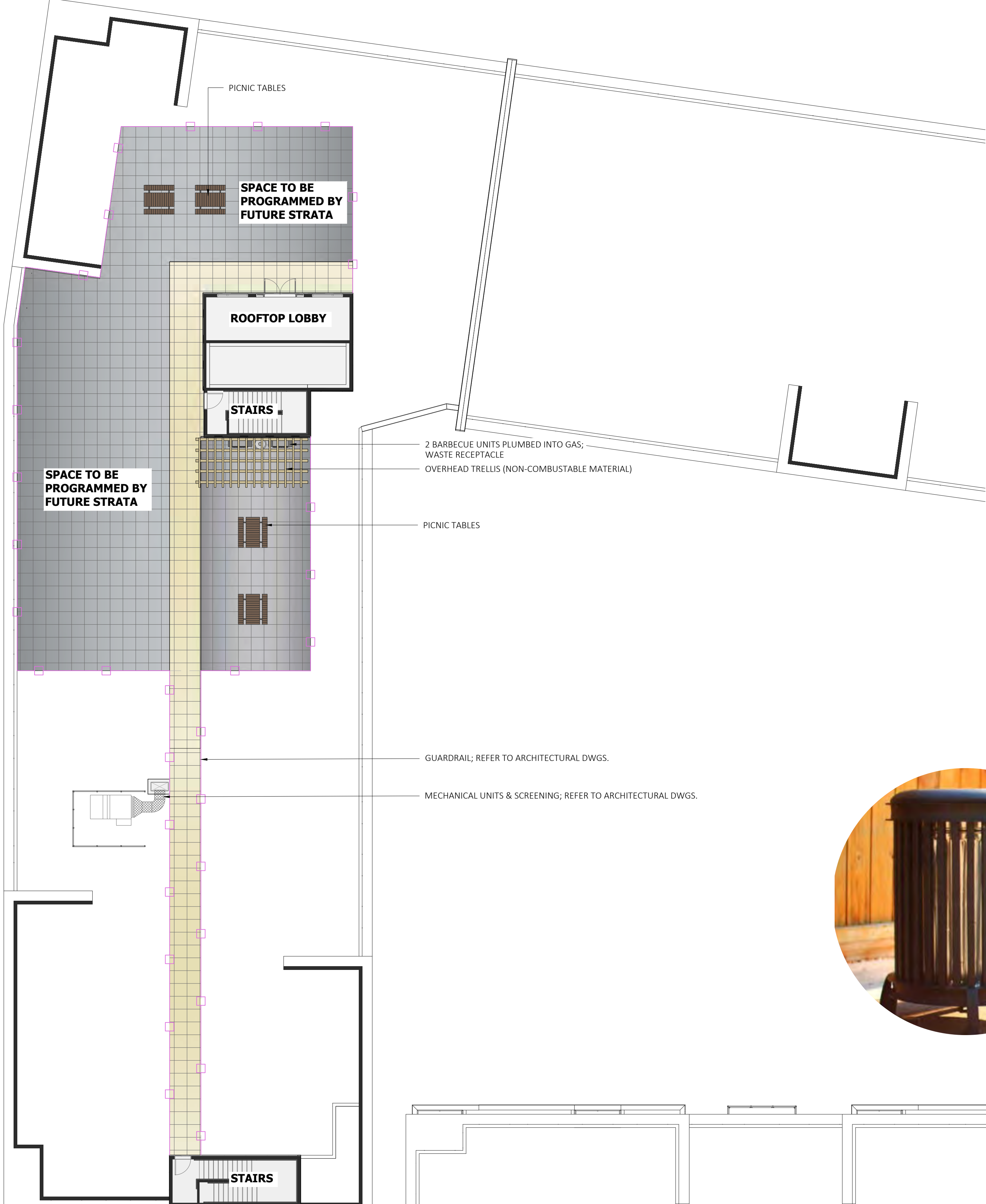

1 ROOFTOP AMENITY - BUILDING A  
1:150

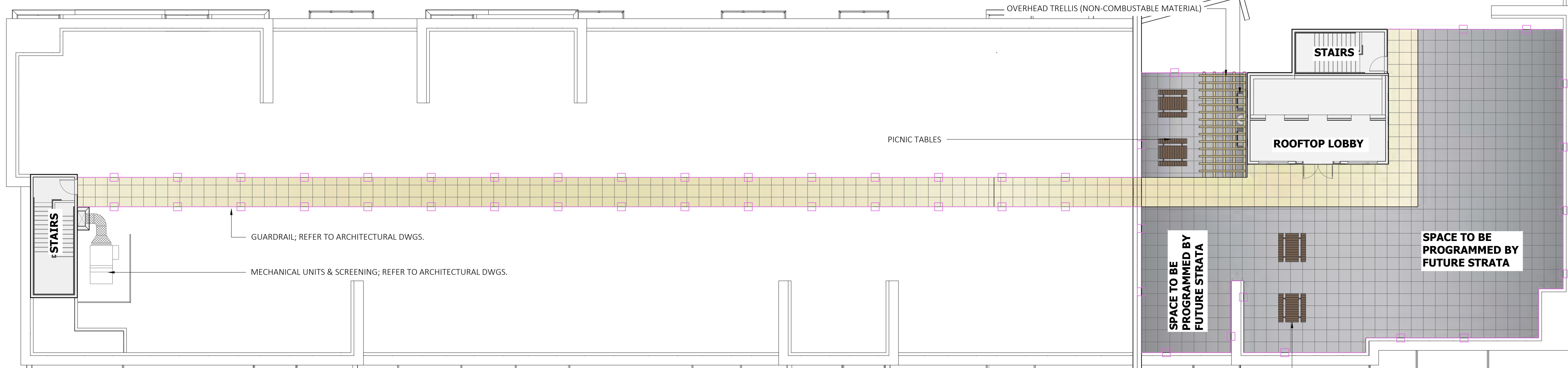

2 ROOFTOP AMENITY - BUILDING B  
1:150

ISSUED FOR  
DEVELOPMENT  
PERMIT

NO.	ISSUE/REVISION	DATE
1	ISSUED FOR 50% SD	26-01-28
2	ISSUED FOR CLIENT REVIEW	26-03-25
3	ISSUED FOR DP	26-03-27

BLACK BEAR CROSSING - BLACK BIRCH HEIGHTS

BLACK BEAR CROSSING SW, TSUUT'INA NATION 145 AB

PROJECT # 25-141  
CITY FILE #

ROOFTOP AMENITY  
PLANS

SCALE 1:150

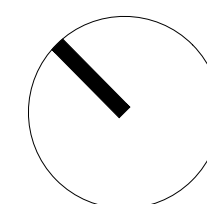

L-1.10

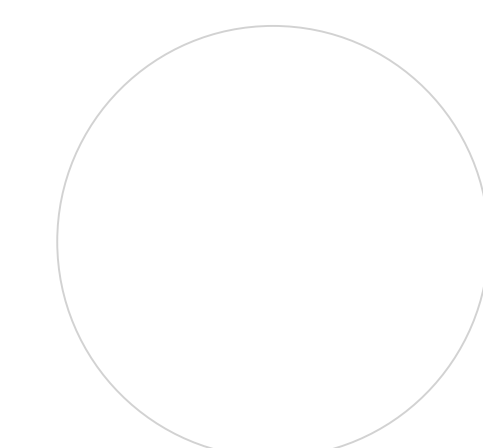

ISSUED FOR  
DEVELOPMENT  
PERMIT

NO.	ISSUE/REVISION	DATE
1	ISSUED FOR 50% SD	26-01-28
2	ISSUED FOR CLIENT REVIEW	26-03-25
3	ISSUED FOR DP	26-03-27

BLACK BEAR  
CROSSING - BLACK  
BIRCH HEIGHTS

BLACK BEAR CROSSING SW, TSUUT'INA  
NATION 145 AB

PROJECT # 25-141  
CITY FILE #



PLANTING  
PRECEDENTS

SCALE #####

L-2.00

- Irrigation Notes:
- All softscape areas to be irrigated in accordance to the CPCIA Standards, current edition. Irrigation to be design-build and shop drawings provided to the Landscape Architect for approval prior to installation.
  - High efficiency nozzles & heads to be used:
    - Shrub/Tree Planting: Drip Irrigation
    - Lawn Areas: High Efficiency Spray
  - Minimum requirements: 50 PSI; 4" PVC sleeving under all pedestrian hardscapes and steel sleeving under all vehicular paths; all products to be installed as per manufacturers specifications.
  - Coordination with civil drawings required
  - Irrigation design and installation must be done by a member in good standing with the CPCIA.
  - The irrigation contractor to provide a written guarantee to the owner covering materials and workmanship for a period of at least one year from the time of landscape substantial completion.
  - The irrigation contractor to provide an O+M manual to the client at time of completion.

SWEET GRASS GARDEN

DRIVEWAY PLANTING AND  
GENERAL LANDSCAPING

PRIVACY SCREENING

RAIN GARDEN

ARCHITECTURAL PALETTE

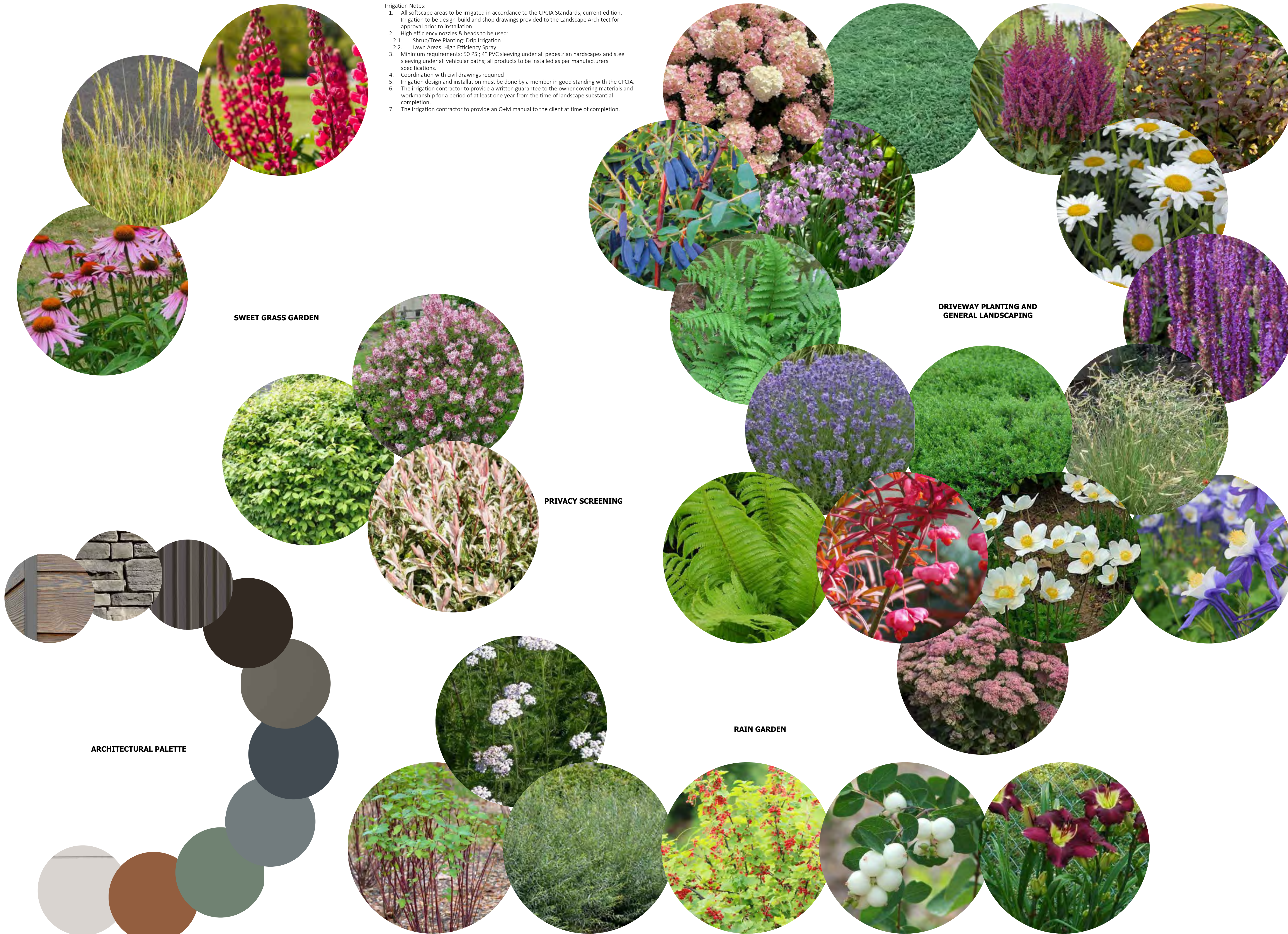

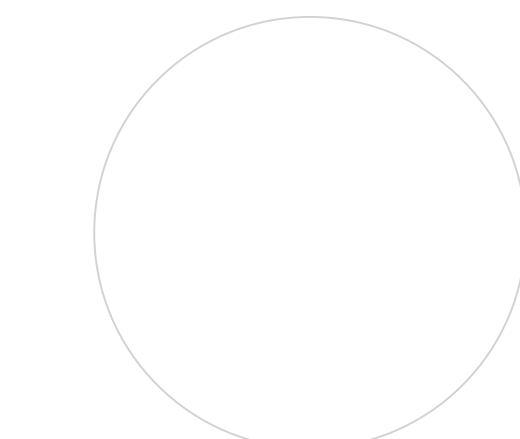

ISSUED FOR  
DEVELOPMENT  
PERMIT

NO.	ISSUE/REVISION	DATE
1	ISSUED FOR 50% SD	26-01-28
2	ISSUED FOR CLIENT REVIEW	26-03-25
3	ISSUED FOR DP	26-03-27

BLACK BEAR  
CROSSING - BLACK  
BIRCH HEIGHTS

BLACK BEAR CROSSING SW, TSUUT'INA  
NATION 145 AB

PROJECT # 25-141  
CITY FILE #



LANDSCAPE  
PRECEDENTS

SCALE #####

L-3.00



CULTURAL ELEMENT;  
LOBBY AREAS WILL INCORPORATE  
TSUUT'INA ARTWORK  
  
ARTWORKS BY KEAGAN STARLIGHT USED  
AS INSPIRATION. EXACT ARTIST &  
ARTWORK TO BE CONFIRMED BY CLIENT



CULTURAL ELEMENT;  
PERGOLA AS CENTRAL GATHERING SPACE

SITE ELEMENTS

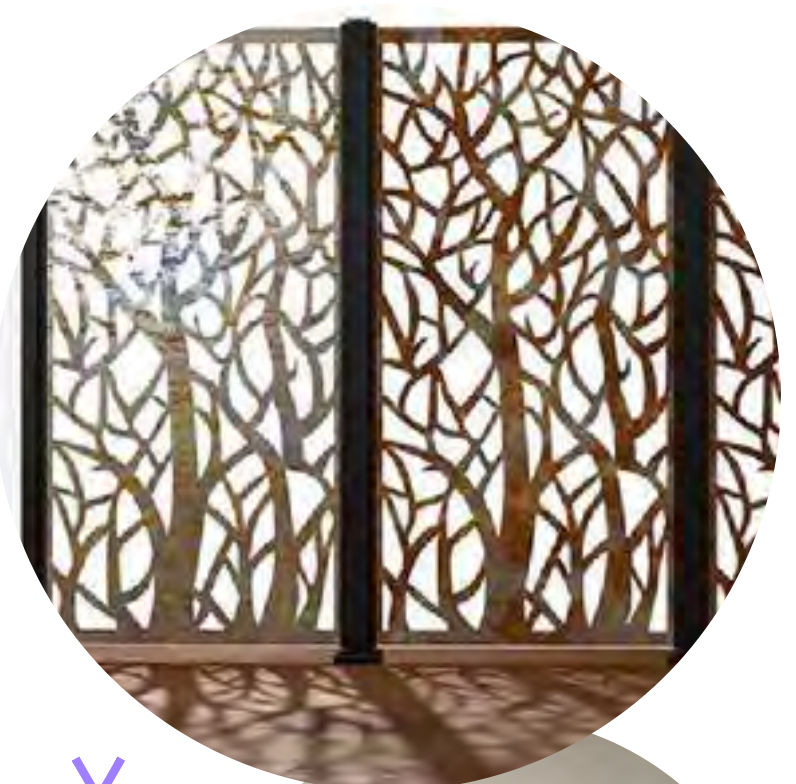

CULTURAL ELEMENT;  
DECORATIVE SCREEN BETWEEN  
AMENITY & MOLLOCKS; TSUUT'INA  
ARTIST TO BE ENGAGED FOR  
DESIGN



TIRED WALLS; CAST IN PLACE  
CONCRETE (NATURAL GREY  
COLOUR) FACING PUBLIC REALM;  
PLANTED WITH MIX OF  
EVERGREEN/DECIDUOUS SHRUBS &  
PERENNIALS



BENCHES, PICNIC TABLES & BIKE RACKS;  
METAL FRAME WITH NATURAL FINISHES



BOULDERS INTEGRATED INTO  
HARDSCAPE AS FUNCTIONAL  
ART/INFORMAL SEATING ELEMENTS

SITE FURNISHINGS



LIGHT BOLLARDS INTEGRATED THROUGHOUT  
LANDSCAPE AT KEY LOCATIONS FOR CPTEO,  
ACTING AS VISUAL DESTINATIONS